



MEMBERSHIP HANDBOOK



Spring Lake
Fitness &
Aquatic Center

WELCOME

On behalf of the entire staff, we would like to welcome you to our FAC family. The FAC is here to support Spring Lake Public School athletes and students as well as enhancing the quality of life for the greater community members by encouraging healthy, active, and balanced lifestyles. Please take the time to talk with any of our staff about how we can help in your fitness journey.

We encourage you to make full use of the programs, facilities, and additional amenities offered. Our facility features a competitive lap pool, family fun pool, fully- equipped weight room, cardio space, auxiliary gym, indoor walking/running track, hot tub, and steam room. Group fitness classes are offered as well as personal training availability. Free equipment orientations are available to introduce you on how to properly use the different pieces of equipment in our weight room. Certified personal trainers are another option to develop a customized fitness plan tailored to meet your goals.

We are looking forward to seeing you become an active member and participant at FAC. If you have any questions or would like additional information, please do not hesitate to contact us.

Thank you for joining the Spring Lake Fitness and Aquatic Center!

TABLE OF CONTENTS

Table of Contents.....	2
About Us	4
Mission Statement.....	4
Vision Statement	4
Hours of Operation	4
Code of Conduct	5
Denial or Revocation of Membership	7
Membership Information	8
Terms.....	8
Dues.....	8
Member Key tag	9
Member App.....	9
Change In Membership Status	9
Membership Hold	10
Membership Cancellation	10
Insurance Disclaimer	11
Guest Policies.....	12
Guest Pass Policy	12
Expectations.....	13
Policies and Procedures	14
General Facility.....	14
Service Animals	15
Elevator.....	15
Locker Room.....	16
Cardio Area.....	17
Weight Room	17
Track Rules	18
Multi-Purpose Gym	19
Aquatics - All Areas.....	19
	2

Pool Closing Policy	20
Competition Pool.....	21
Diving Well.....	21
Diving Board	21
Hot Tub	22
Steam Room	23
Family Pool - General	24
Family Pool - Slide	24
Family Pool – Lily Pads	25
Little Lakers Activity Center.....	26
Programming.....	26
General Policies.....	27
Group Fitness Classes	27
Specialty Classes.....	28
Swim Lessons & Private Swim lessons.....	28
Personal Training	28
Facility Map.....	30

ABOUT US

MISSION STATEMENT

We educate, empower and inspire SLPS Students and the greater community to achieve their highest potential.

VISION STATEMENT

Our staff is dedicated to delivering excellent service and programs for the benefit of all, as well as continually strive to be an industry leader in the fields of fitness, aquatics, health, and well-being.

HOURS OF OPERATION

Monday - Thursday: 5:05am-9:00pm

Friday: 5:05am-8:00pm

Saturday: 7:30am-4:00pm

Sunday: 12:00-4:00pm

During posted facility hours members have access to the weight room, cardio area, track, hot tub, and steam room. The multi-purpose gym, competition pool, family pool, and Little Laker activity center have specific hours of operation within facility hours. Activities in these areas include pickleball, lap swim, and family swim with their own scheduled times. Check with our front desk or slfac.com for up to date schedules.

Please note: throughout the school day, in addition to being open for members, the facility will be used for physical education classes and sports team sessions. Availability subject to change as circumstances may require temporary adjustments.

CODE OF CONDUCT

The FAC is committed to providing a safe and welcoming environment for all members and guests. To promote safety and comfort for all. Members and guests are asked to act appropriately at all times.

Members and guests using the FAC are expected to behave in a mature and responsible manner and to respect the rights and dignity of others. This Code of Conduct does not permit language or actions that can hurt or frighten another person or that falls below the generally accepted standard of conduct.

Specifically, the following activities are prohibited on FAC property:

- Angry or vulgar language such as swearing, name calling, or shouting.
- Intentional physical contact with another person in an angry, threatening, or sexual manner.
- Any comment, conduct, or activity of a sexual nature.
- Harassment or intimidation by words or gestures, body language, or any other menacing behavior.
- Any other conduct that is inappropriate, threatening, or offensive in nature.
- Wearing inappropriate attire. Inappropriate attire includes, but is not limited to the following: clothing that references beer, alcohol, tobacco, or drugs; clothing that contains or depicts inappropriate language, symbols or innuendos; clothing that fails to protect the privacy of the person

wearing it; and, clothing that is not intended or designed for physical exercise.

- Theft or behavior that results in the destruction of property.
- Thus use of alcohol or tobacco on the premises.
- Carrying or concealing weapons and/or objects that may be used as weapons.
- The use of cell phones with cameras, and the use of any other camera or video recording device, in any bathroom, locker room, changing area, or other place where there may be reasonable expectation of privacy.
- Knowingly utilizing the facilities in such a way or at such time as may reasonably pose a threat to the health, safety or well-being of yourself, other members, guests or staff (e.g. with a communicable illness, disease, or condition, outside operational times, posted hours or signage, etc.).
- Significant or chronic disregard for the FAC policies, rules, codes or expectations.

Members and guests are encouraged to be responsible for their personal comfort and safety. If the behavior of a member or guest is in violation of the Code of Conduct, please ask the individual to stop the offensive behavior and/or report it immediately to a FAC staff person.

Members and guests should not hesitate to notify a staff person if assistance is needed. The staff strive to make your visit to the FAC the best part of your day.

The Fitness and Aquatic Director, and the Superintendent of Spring

Lake Public Schools, will review all reported incidents. The decision to suspend or terminate Spring Lake Fitness and Aquatic Center membership or guest privileges will be made at their discretion if a violation of the Code of Conduct, and/or a violation of other facility rules, policies, or expectations has occurred.

DENIAL OR REVOCATION OF MEMBERSHIP

The Fitness and Aquatic Director and the Superintendent of Spring Lake Public Schools have the authority to deny or revoke membership and/or guest privileges to any individual if it is determined by them that said individual's presence and/or behavior, etc. may jeopardize the comfort, safety, health or well-being of others. This includes, but is not limited to convicted sex offenders, drug traffickers, violators of facility rules, code of conduct, or facility/program policies.

In the event membership privileges are revoked, the unused portion of the member's fees will be refunded on a pro-rated basis.

MEMBERSHIP INFORMATION

TERMS

All memberships to the Spring Lake Fitness and Aquatic Center automatically renew until 30 days written notice is provided to cancel.

Memberships are non-transferable.

Liability waiver must be on file for all members.

DUES

Payment of dues can be paid annually, semi-annually, quarterly, or monthly.

Monthly payers are required to have a credit card on file; monthly dues are charged on the 10th of each month.

Quarterly, Semi-Annual, or Annual payers can pay via cash, check, or credit card. If a credit card is on file, the card will automatically be charged on the due date.

Declined Credit Cards are subject to a \$5 late payment fee.

Returned checks will incur a \$25 charge.

The FAC will attempt to collect membership dues for 30 days before cancelling the membership. Cancelled memberships are subject to the \$50 initiation fee upon rejoining.

SL FAC reserves the right to change the membership dues at any time.

MEMBER KEY TAG

The FAC is a membership organization. A photo and personal information are collected and maintained in our database.

Membership key tags are issued and must be scanned each visit. If you forget your card, you must check in at the front desk before using the facility.

If you lose your key tag, you may use the app, access code number (check with the front desk), or purchase a replacement key tag for a nominal fee.

MEMBER APP

The FAC has a membership app, which can be found in any app store by searching 'SL Fitness'. The app is free to download. The app includes the ability to scan in to the facility from your phone, signing up for group fitness classes, viewing classes you have signed up for, viewing pool schedules, and updates about equipment orientations.

CHANGE IN MEMBERSHIP STATUS

Your membership type and payment frequency can be changed by completing a Status Change Form available at the front desk. There is a \$5 fee that will be applied to any membership change. Changes to membership type (adding or removing family or moving to an insurance membership) are allowed once every 3 months. Changes to payment frequency (moving from annual to monthly or vis versa) can ONLY be made once per year.

MEMBERSHIP HOLD

All monthly contracts are eligible to go on hold. Annual memberships do not qualify for the hold option.

Monthly Memberships, excluding Senior and Student memberships, have a minimum of 1 month and maximum of a 4 month hold in a calendar year.

Senior and Student Memberships can be put on hold, at no cost, for a minimum of 1 month and a maximum of 6 months in a calendar year.

Membership Hold Forms are available at the front desk and cannot be retroactively started. All holds must be in full month increments. The \$10 fee will not be refunded if returning from hold early. When your hold ends, your membership will automatically reactivate.

In the event you would like access to the FAC and would like to prematurely end your hold:

- Pay a \$10 guest fee and be your own guest on a day by day basis.
- If you return during any month you are hold you will be charged for that full month and your planned hold will be terminated and your associated billing will become active.

MEMBERSHIP CANCELLATION

If you wish to terminate your membership with the FAC, written notice is required.

All monthly memberships cancellations are effective at the end of the next month following cancellation submission date. All monthly memberships are paid one month in advance.

For termination notices on annual contracts, written cancellation notice must be provided before your next payment due date, in order to avoid paying for the next term.

If the membership is reopened, an initiation fee of \$50 will be applied.

INSURANCE DISCLAIMER

It is the member's or participant's responsibility to provide his or her own accident and health insurance. Neither Spring Lake Public Schools nor the FAC provides such coverage for members or other participants.

GUEST POLICIES

Guests must be sponsored & accompanied by an active member.

Guests must pay the single visit fee (\$10) to use the facility.

Guests under the age of 13 must be accompanied and supervised by an adult 18 years of age or older.

Guests must check-in at the front desk, have waiver on file, and be with their member sponsor at the time of check-in. All guests under the age of 18 must present a waiver signed by their parent/guardian, along with a contact number.

Guests must abide by all facility policies, rules, and code of conduct.

GUEST PASS POLICY

All Annual Memberships are eligible for a 10 free guest pass package at the beginning of their contract (new sign ups starting 07/01/2025).

All guest passes **MUST** be used before June 30th of the following year. Guest Passes do not roll over if left unused.

Only one package per membership. All active members listed on the membership will have access to this guest pass package.

If you're planning to change your membership status the following rules apply to the guest pass packages:

- Moving from Monthly to an Annual Membership qualifies you to receive a 10 guests pass package
- Moving from an Annual to a Monthly Membership forfeits

your guest pass package

- If you decide to change your membership type the number of remaining guest passes will remain the same, none will be added.

EXPECTATIONS

Members and guests can expect:

- A safe, clean and comfortable facility with well-maintained equipment
- Staff to be properly trained, knowledgeable, courteous and helpful
- Broken equipment to be repaired in a timely manner, when parts are on hand.

The FAC staff can expect members and guests to:

- Bring their membership card and adhere to facility rules, policies, and code of conduct
- Follow the Code of Conduct stated in this member handbook
- Report any safety concerns to the staff
- Use the equipment properly, such as weights, cardio equipment, etc., and ask for assistance if needed
- Return equipment to its proper location

Please share your comments and concerns and feel free to contact us at 616-847-5858 or fac@springlakeschools.org.

POLICIES AND PROCEDURES

GENERAL FACILITY

- All members must present their membership card or provide membership number upon entering the building.
- Youth under the age of 13:
 - Require direct supervision by an adult (18+). Direct supervision is defined as an adult in the same activity
- The FAC is not responsible for lost or stolen items.
- The FAC is an alcohol and tobacco/smoke free facility, including vaping.
- Food and beverage items are allowed only in designated areas of the facility
- Closing for weather will be announced via the FAC website, Facebook page, and FAC phone line.
- All programs and activities will end at least 15-30 minutes prior to the scheduled closing time, to allow members to vacate the facility in a timely manner.
- Personal music players may only be used with headphones or earplugs.
- The use of any camera cell phone or of any other camera or video recording device is PROHIBITED in any bathroom, locker room, changing area, or other place where there may be a reasonable expectation of privacy.
- Entry and exit are only permitted through the main

entrance; except in the case of an emergency.

- FAC members must adhere to our dress code in each designated area.

SERVICE ANIMALS

The Fitness & Aquatic Center shall comply with the provisions of the American with Disabilities Act (ADA), as amended, regarding an individual with disability's use of a service animal.

- Individuals with disabilities shall be permitted to be accompanied by their service animals in all areas of the facility where members of the public, as participants in services, programs or activities, or as invitees, are allowed to go.
- **Service animal** means any dog that is individually trained to do work or perform tasks for the benefit of an individual with a disability, including a physical, sensory, psychiatric, intellectual, or other mental disability. Other species of animals, whether wild or domestic, trained or untrained, are not service animals for the purposes of this definition.

ELEVATOR

Access to the elevator within the SLPS High School is restricted to authorized FAC members only. The elevator is provided strictly for the purpose of direct access to the Fitness & Aquatic Center.

All members must adhere to the following guidelines:

- **Direct Access ONLY:** Upon accessing the elevator, members must proceed directly to and from the Fitness & Aquatic Center only.

- **Restricted Areas:** Members may not enter or loiter near classrooms, academic hallways, or other unauthorized spaces within the High School building.
- **Disruption Prohibited:** Interruptions to classes, students, or faculty is strictly prohibited.
- **No Deviations:** Any member who veers from the permitted pathway is in violation of SLPS campus policies and may be subject to charges and possible revocation of membership privileges.

These expectations are in place to ensure the safety, privacy, and integrity of both the academic and recreational spaces.

LOCKER ROOM

- The use of any camera/cell phone or video recording device is PROHIBITED in all bathrooms, locker rooms, and changing areas.
- Lockers may be used on a daily basis; users should bring their own lock. Due to the limited number of lockers available, lockers will not be rented.
- Padlocks provided by members or guests must be removed daily. Locks left on lockers overnight will be removed and discarded.
- The FAC is not responsible for personal items left in the locker room. It is recommended that valuables not be brought to the facility.
- The FAC has 4 family locker rooms for your convenience.
- Children ages 4 and under are allowed in the opposite

gender locker room as long as they are supervised by a responsible adult. Adults with children of the opposite gender that are over the age of 4 must use the family locker rooms.

CARDIO AREA

- Youth under the age of 13 are required to have an adult 18+ directly supervising them in the cardio area.
- All members and guests under the age of 18 are required to demonstrate proficiency on how to use the cardio equipment. If unable to demonstrate proficiency, a staff member may be contacted to demonstrate proper use.
- Appropriate exercise attire must be worn. Shirt and shoes required. No shirts with extreme exposure (ex: sports bras or extreme cut off tanks are inappropriate).
- Appropriate shoes must be worn (no open toed shoes or cleats allowed).
- Equipment must be used properly. If it is found that you are not using equipment properly, you will be instructed on proper usage and/or denied further use.
- Equipment should be wiped down by members after each use with the provided wipes.

WEIGHT ROOM

- Youth under the age of 13 are required to have an adult 18+ directly supervising them in the Weight Room.
- Appropriate exercise attire must be worn. Shirt and shoes required. No shirts with extreme exposure (ex: sports bras

or extreme cut off tanks are inappropriate).

- Appropriate shoes must be worn (no open toed shoes or cleats allowed). Shoes must have a back. Crocs and boots are not appropriate.
- Equipment must be used properly. If it is found that you are not using equipment properly, you will be instructed on proper usage and/or denied further use.
- Weights should be returned to appropriate storage locations after use.
- No standing on weight room benches.
- Do not drop weight plates, dumbbells or bars on benches, platform, or floor; this can cause damage to the weights and/or benches.
- Equipment should be wiped down by members after each use with the provided wipes.

TRACK RULES

- Track direction: Counter-clockwise Monday, Wednesday, Friday and Sunday; clockwise Tuesday, Thursday and Saturday.
- Walkers should use the inside lane and runners should use the outside lane.
- Appropriate exercise attire must be worn. Shirt and shoes required. No shirts with extreme exposure (ex: sports bras or extreme cut off tanks are inappropriate).
- No street shoes allowed. Only non-marking soles are permitted on the track.

- Youth under the age of 13 are required to have an adult 18+ directly supervising them on the Track.

MULTI-PURPOSE GYM

- Check with the front desk or online for multi-purpose gym schedules, includes designated pickleball and open gym times.
- No food, drink, glass containers, or gum is allowed in the multi-purpose gym.
- No street shoes are allowed on the court.
- Wrestling mats, boxing bags, hand weights and stability balls are used for classes and programs only.
- No horseplay is allowed.
- Youth 13 and under must have direct supervision by an adult (18+)

AQUATICS - ALL AREAS

- No swimming if a lifeguard is not on duty.
- Patrons of the aquatic center must obey the directions of the on-duty lifeguard.
- State law requires all individuals must shower before entering the pool.
- Appropriate swimming attire is required. No cotton clothing ; No under garments of any kind; No compression garments; No see-thru clothing.
- No one with open sores or wearing bandages will be

allowed in the pool.

- Patrons should shower before entering the pool and before entering the hot tub
- No running, pushing, dunking or horseplay is allowed in pools, on pool decks, in locker rooms or in spectator areas.
- Street shoes must be clean when worn on the pool decks.
- Swim diapers must be worn by swimmers not in control of bodily functions, and must be covered by a bathing suit.
- Parts of the pools, hot tub, diving board, diving well or water slide may be opened or closed at the lifeguard's discretion.
- Aquatic Center users must abide by all pool, spa and other facility rules, policies and codes.
- Youth under the age of 13 are required to have an adult 18+ directly supervising them when using any of the pools.
- No food, drink, glass containers, or gum allowed in the pool areas (including but not limited to the hot tub and steam room areas). Only beverage allowed on deck is water.

POOL CLOSING POLICY

- **Fecal Accidents:** Pool may close unexpectedly due to fecal incidents. Depending on the incident, the pool may be closed anywhere from 30 minutes to 24 hours.
- **Mechanical Failure:** Pool(s) may close unexpectedly due to mechanical failure. Pool(s) will open as soon as the mechanical failure is corrected and the pool(s) are chemically balanced.

COMPETITION POOL

- Lifejackets & puddle Jumpers are not permitted in the competition pool
- No hanging on lane lines. Please swim under, rather than over the lane lines.
- Starting blocks are for use during supervised swim team practices/meets and lessons; not for public use.
- No diving is allowed in the shallow areas of the competition pool.
- Anyone showing signs of trouble in the water will be required to complete a deep end water/lap lane test before using the diving well or lap lanes. Once this test is completed, a record of completion will be kept for future visits.

DIVING WELL

- Those under the age of 13 and weak swimmers must pass a swim test to use the diving well.
- During times designated as lap swim, the diving well is available for general exercise purposes (except when classes are scheduled)
- Diving boards are not open during lap swim designated times; only during open swim times
- Group fitness equipment is available during lap swim times, but not during open swim times.

DIVING BOARD

- Diving board is only available during designated open swim times when there are two lifeguards on duty in the competition pool.
- Anyone showing signs of weak swimming must pass a swim test prior to using the diving board.
- Swimming directly in the diving area is NOT allowed, while the diving board is in use.
- Only one diving board will be open at a time.
- Only one person is allowed on the diving board at a time.
- Only one bounce for each dive.
- Dive straight off the board; swim to the side immediately after surfacing from a dive; do not swim back under the diving board.
- No running on the diving board.
- Diving board fulcrum must stay at the number 1 position.
- Only feet first jumps and front dives are allowed.
- Flips, twists, cartwheels, handstand dives, back dives, and inward dives are not allowed.
- Lifejackets and other floatation devices are not allowed off the diving board.
- Goggles and facemasks are not allowed off the diving board.

HOT TUB

- Water Temperatures is 103 degrees.

- The use of the hot tub alone is discouraged.
- For safety reasons, children under the age of 14 are not permitted in the hot tub.
- The elderly, pregnant women, and anyone with a health condition requiring medical care should consult a physician before using the hot tub.
- Use of the hot tub while under the influence of alcohol, narcotic drugs, or medicine may lead to serious consequences and is prohibited.
- Please turn off the waterfall and hot tub jets if you are the last person to exit.
- The hot tub closes 15 minutes prior to the facility.

STEAM ROOM

- Steam room sensor is not to be touched. This will disrupt the ability to keep proper temperature and break the sensor.
- The steam room cycles off for 20min to recalibrate and will resume steam once it has gone through recalibration and sensed temperature.
- For safety reasons, children under the age of 14 are not permitted in the steam room.
- The elderly, pregnant women, and anyone with a health condition requiring medical care should consult a physician before using the steam sauna.
- Long exposure may result in nausea, dizziness, and/or

fainting.

- The use of the steam room alone is discouraged.
- Use of the steam room while under the influence of alcohol, narcotic drugs, or medicine may lead to serious consequences and is prohibited.
- Bathing suits are required to be worn. Compression shorts or undergarments of any kind are NOT allowed.
- The steam room closes 15 minutes prior to the facility.

FAMILY POOL - GENERAL

- No diving is allowed in the family pool.
- Non-swimmers and children under 48" tall must be accompanied and supervised by a competent adult in the pool area.
- A child who is under 48" tall and unable to pass a swim test is allowed in the shallow play area of the family pool if he/she is within arm's reach of a competent supervising adult or wearing a USCG-approved jacket.
- Life jackets must be United States Coast Guard (USCG) approved. Puddle jumpers are USCG approved, but inflatable arm bands (swimmies) are not.
- Inner tubes, noodles and other inflatables are not allowed.
- Toys including but not limited to: beach balls, noodles, nerf balls, tennis balls, foot balls etc. are not allowed

FAMILY POOL - SLIDE

- Riders must be at least 48" tall.
- Maximum load is 300 pounds.
- Arms, legs, and hands must remain inside the slide.
- Riders must go feet first, either lying on their back or in a seated position.
- Wait for attendant's signal before starting; bottom of slide must be clear before the next ride can start.
- Do not attempt to stop while on the slide.
- After exiting the slide, obey all instructions by the lifeguard and exit quickly.
- Lifejackets are not permitted on the slide.
- Swimwear with exposed zippers, buckles, rivets, or metal ornamentation is not permitted.
- For safety reasons, pregnant women and individuals with heart conditions or back trouble should not ride the slide.

FAMILY POOL – LILY PADS

- One-way directional use starting from the North (lazy river) side and going South
- No running starts
- If a swimmer falls off, they should swim out of the way of the next user; they should not attempt to get back on the lily pads
- Parents are allowed to walk alongside the lily pads to assist small children in crossing.

LITTLE LAKERS ACTIVITY CENTER

- Little Lakers activity center will be closed on some major holidays.
- Child must be on the membership to use the activity center.
- Child must be between the ages of 18 months & 8 years
- A child's stay, at the activity center, is limited to 1.5 hours.
- Due to food allergies, snacks and drinks are not allowed in the child care.
- Parents are responsible for remaining on the premises while their child is in child care.
- Parents must sign child in and out each visit.
- Parents must change diaper or make sure that your child has used the bathroom before dropping off, if necessary.
- Please leave all toys at home.
- Sick children are not permitted in child care. If your child becomes ill while visiting, parents will be notified and asked to check the child out immediately for the safety of the other participants.

PROGRAMMING

Additional programming is offered throughout the year and scheduled on a seasonal basis. Each class requires an additional fee to participate. Class schedule and fees can be obtained online and at the front desk.

GENERAL POLICIES

- Registration is required for participation in all FAC programming.
- Additional offerings are available throughout the year and scheduled on a seasonal basis.
- Class schedules and fees can be obtained online and/or at the front desk.
- Additional programming is non-refundable and must be paid at time of registration.
- Open to the FAC members and non-members (excluding Group Fitness Classes).
- Let your instructor know if you have any medical conditions or are pregnant.
- For safety reasons, there is no admittance 5 minutes after class begins.
- Please be quiet and respectful outside of the class that is currently in session.
- All no-shows may be charged a nominal fee.

GROUP FITNESS CLASSES

- A FAC Member only based program.
- Water bottles and towels are recommended.
- Must be minimum of 13yrs old to attend.
- Please sanitize and put away equipment at the end of class.
- Group Fitness classes are available for a monthly unlimited pass or pay per class option.
- Classes sizes are limited. You must register for a class prior to attending; if a class is full, members may put their name on the wait list.

- The waitlist is managed by membership software. You will receive an e-mail if you are moved off the waitlist.
- Reservations can be made up to one week in advance using the FAC app or by contacting the FAC front desk.
- If you cannot attend a class, we ask that you cancel at least 30 minutes in advance.

SPECIALTY CLASSES

- Each class is unique and instructed by a certified trainer.
- Offered for a designated period of time, developed based on instructor or member's requests; fun and ever-changing programs.
- Specialty Classes are not included with our Group Fitness class pass.
- Discounted rates available for Annual Members. Discount determined based on class type.

SWIM LESSONS & PRIVATE SWIM LESSONS

- Schedule and fees can be obtained online or at the front desk.
- Offerings available in Group Lessons from 6 months to age 13.
- 1:1 available to ages up to 16

PERSONAL TRAINING

Our personal training program provides individuals with a tailored plan that includes, but is not limited to various exercise techniques, proper equipment instruction, plus motivation and support, in order to meet your fitness needs/goals.

- Personal Training is available for a package rate or pay per session option.
- Personal Training is based on instructor availability.

FACILITY MAP

Main Level:

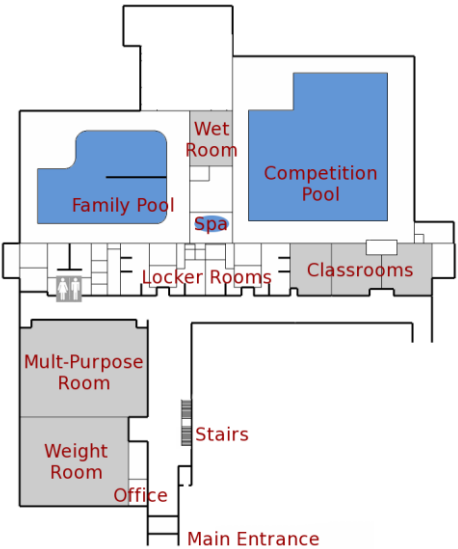

Upper Level:

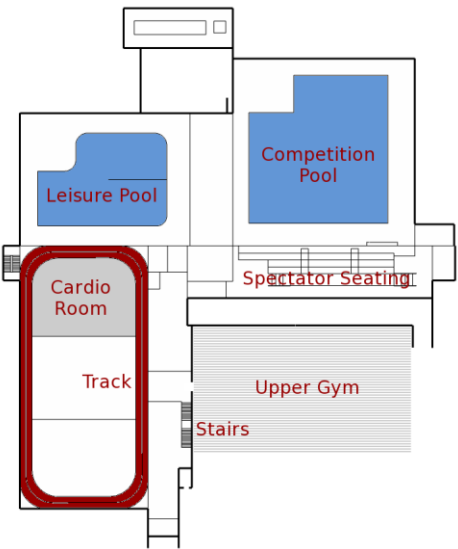



Like us on Facebook:
Spring Lake Fitness & Aquatic Center



Download our app: SL Fitness

*Google Play and the Google Play logo are trademarks of Google LLC.
Apple and the Apple Logo are registered trademarks of Apple Inc*

16140 148th Ave., Spring Lake, MI 49456

616.847.5858 | www.slfac.com

Version: 20250701